

WHY WARMUP HEATING?

Since 1984, Warmup has provided safe, comfortable and economical heating to thousands of satisfied customers throughout South Africa. Consider these benefits of our new improved heating system.

SAFE

Warmup heating cables are factory tested at 5000 Volts. The element insulation is tough, completely waterproof and resistant to chemical attack.

UNOBTRUSIVE

Discreetly hidden from view. There are no visible elements or radiators. No summer-time storage problems.

TECHNOLOGY

Warmup components have the benefit of over 30 years of European technology for applications that demand harsh conditions, continuous operation at high temperatures and long working life.

CONTROL

While Warmup heaters have been designed to never overheat - and may be left on continuously - timers and thermostats are available as optional extras for additional control.

OVERALL-WARMTH

Warmup CAN cover up to 100% of the available floor area if required. This provides even heating with no cold areas (cold spots).

GUARANTEE

A 5 year factory-backed warranty covers our range of heaters.

SERVICE

We take pride in providing quality products and excellent customer service through our network of authorised dealers.

ECONOMICAL

Undercarpet and Underfloor heating has a vastly quicker response time when compared to conventional underfloor heating. You only heat the area you need, when you need it.

To give you an idea of the economy of Warmup...

A typical bathroom of 2.5sqm uses less power than three 100 Watt light bulbs.

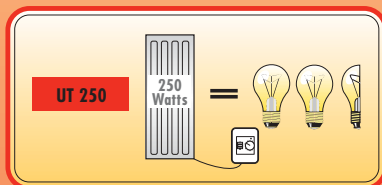

THE ADVANTAGES

PROVEN BENEFITS

- Warmup is healthy, no dry heated air to aggravate allergies or asthma •
- Increases the value of your home •
- Evenly dispersed warmth throughout your home •
- Temperature controllers (air and floor sensing) give you precise control of comfort levels •
- No more cold floor tiles and cold feet •

ADVANTAGES OVER CONVENTIONAL HEATING METHODS

- Energy efficient and economical to run •
- Environmentally friendly •
- Completely safe •
- Zero maintenance •
- No noise •



WARMUP HEATING SYSTEMS INC.

Contact us for more information on our comprehensive range of floor heating systems

54 Richard Road Industria North Roodepoort Gauteng South Africa
PO Box 80130 Ridgeview 1701
Tel: +27 11 673 5063
Fax: +27 11 673 4827
e-mail: info@warmup.co.za
website: www.warmup.co.za

FOR WARMTH YOU CAN COUNT ON

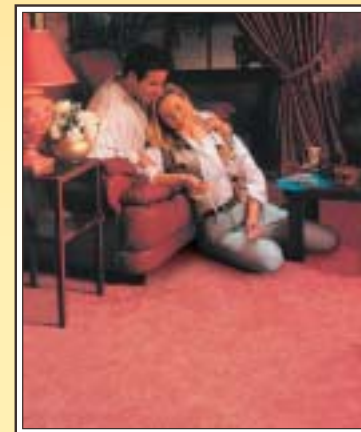

- The unobtrusive heating alternative • Full-room, balanced heating •
- Comprehensive range of attractive controllers • Robust, reliable and economical operation •
- Established 1984 • Countrywide network of authorised dealers • Safety tested internationally •
- 5 year factory warranty •

CALL 0800 00 65 65 TOLL FREE



WARMUP HEATING SYSTEMS INC.

Heating for every floor surface

UNDERCARPET HEATING

REPAIRABLE

- The heating systems are all robustly designed.
- However, where accidental damage occurs, the heating system can be conveniently repaired by an approved technician.

SAFETY

- Foil base forms safety "earth shield" against accidental puncture or damage.
- Heaters designed to never overheat.
- Foil base and cable is waterproof.

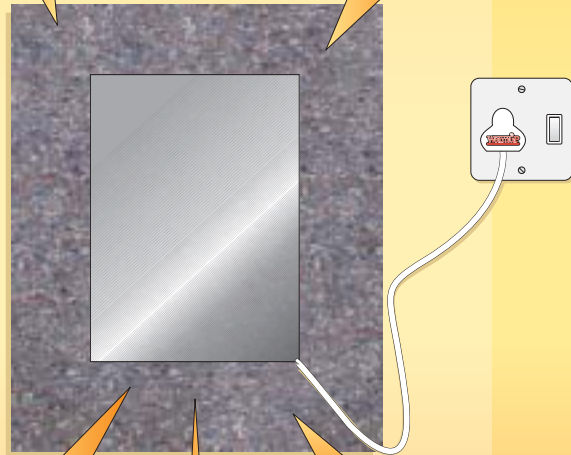

CONTROL

- Simple to operate.
- Simply switch on or off at a wall socket.
- Warmup heaters may be left on continuously.
- Thermostats and timers are optional extras.

UNDERLAY

- A good acrylic underlay prevents downward heat loss.
- A minimum of 1000gsm underlay should be used.

ROBUST CORE WIRE

- Spring like flexibility
- Rayon core acts as a durable cushion, and copes adequately with heavy furniture, snooker tables, stiletto heels and the like.

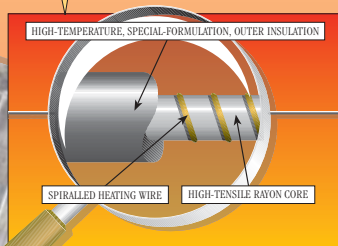

UNDERTILE HEATING

ROBUST HEATING WIRE

- Slim cable construction, thickness less than 2mm.
- Extremely strong with high electrical and mechanical strengths.
- Strong outer Fluoropolymer insulation is highly resistant to chemical attack.
- No maintenance.

COMFORT

- Installed directly beneath virtually any floor covering.
- Warmth can be felt within an hour.
- Economical to run.
- No summertime storage problems.
- There are no visible elements or radiators.

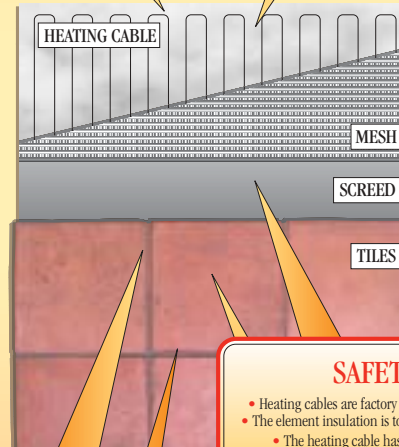

SAFETY

- Heating cables are factory tested at 5000 Volts.
- The element insulation is tough and waterproof.
- The heating cable has been designed to never overheat.

REPAIRABLE

- Warmup heating cables are all robustly designed.
- However, where accidental damage occurs, the heating system can be conveniently repaired by an approved technician.

INSTALLATION

- Simple installation - when building or renovating.
- Changes in floor levels are minimal.
- Heating cable may be installed on new or existing floors.
- Fully concealed installation permits full use of living or working area.

HEATING FORMULA

- Calculate wall to wall area in square metres.
E.g. Main bedroom is 5.00 x 5.00 = 25m²
25m² x 80 Watts heat = 2 000 Watts required.
Therefore a minimum of 2 000 Watt heating wire should be installed.

IMPORTANT

- Very cold rooms, high ceilings and open plan areas should be calculated at 100 Watts per square metre rather than 80 Watts per square metre for required heat.

MICROTEMP ELECTRONIC THERMOSTATS

Air and floor sensor thermostats.

AIR SENSOR THERMOSTAT

- MTC - 1999 - UCH with built-in air sensor.
- Air sensor thermostat is used for room heating.
- Mounted approx. 1.2m above floor.
- Direct sunlight and draughty areas should be avoided.
- Maximum and minimum heat limitation locks.

FLOOR SENSOR

- Microtemp thermostats for regulation, limitation and protection against excessive temperatures. Never exceed 27 degrees Celsius for laminate wood floors.
- Simple to install.
- Floor sensor is installed between the heating wire.
- Diameter of sensor cable 6.5mm.
- Floor sensor with 3.00m cable, can be extended.



- Protective cover - Polar white

- Red LED indicates when heating is on.

- Ambient temperature operation 0/ +50 degrees Celsius

- On/off 2-pole isolator switch
- Complies with SABS 0142 Code of Practice

DESIGN

- Microtemp is a range of Electronic thermostats in an elegant design.
- The range comes with a 16A output relay (3500watt).
- Flush mounting in standard 100 x 50mm wall box.
- Voltage supply 230 Vac.
- Dimensions:
Height 115mm Width 84mm Depth 58mm

APPLICATION

- If the purpose is to attain a comfortable floor temperature in e.g. bathrooms, we recommend that the thermostat is installed with a floor sensor. If the room heating is the primary purpose, an air sensor thermostat should be used.